

A0721

REV

11/18/2013

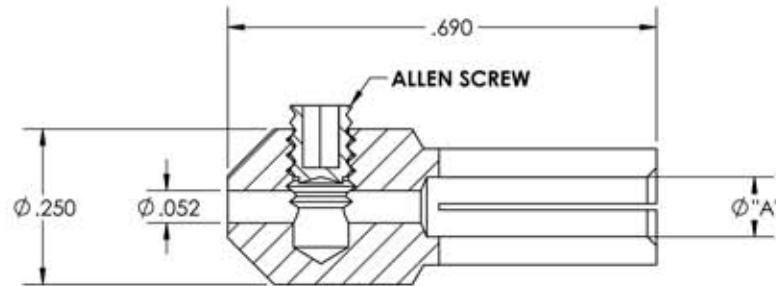

PART #	$\phi "A"$ DIM
A0721-1-CN	.094
A0721-2-CN	.050
A0721-3-CN	.040
A0721-4-CN	.060
A0721-5-CN	.089
A0721-6-CN	.125

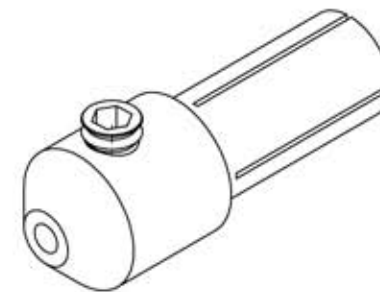

Operating Temperature up to 150°C Air / 200°C Vacuum

APPROVED

Push-on Connectors, Beryllium-Copper alloy, Package of 10

TITLE:

POWER CONNECTOR,
PUSH-ON, Be-Cu, PIN

PROPRIETARY AND CONFIDENTIAL		UNLESS OTHERWISE SPECIFIED:		MPF PRODUCTS INC.				
ANY REPRODUCTION IN PART OR AS A WHOLE WITHOUT THE WRITTEN PERMISSION OF MPF PRODUCTS INC. IS PROHIBITED.		DIMENSIONS ARE IN INCHES TOLERANCES:			FINISH	DRAWN BY	JB	DATE
USED ON:		ANGULAR: MACH ± 1/2 ° TWO PLACE DECIMAL THREE PLACE DECIMAL			CONNECTOR	CHECKED		
		± .030 ± .015		DO NOT SCALE DRAWING	ENG APPR.	JB		SIZE A DWG. NO. A0721 REV 11/18/2013
						LAST SAVED DATE		Wednesday, November 13, 2013 2:35:52 PM



Engineering Assistance
Custom parts & modifications
Available on all parts

In-House Manufacturing
Manufactured on-site to
our high quality standards

Fast Turnaround
Quick shipping on stock parts
and quick design on custom parts

For Questions or to Order:

1-866-429-4224
MPFPI.com
sales@mpfpi.com