

A0192-8-CF

REV

5/2/2013



Ø 1.33 C.F.

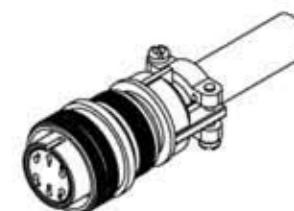
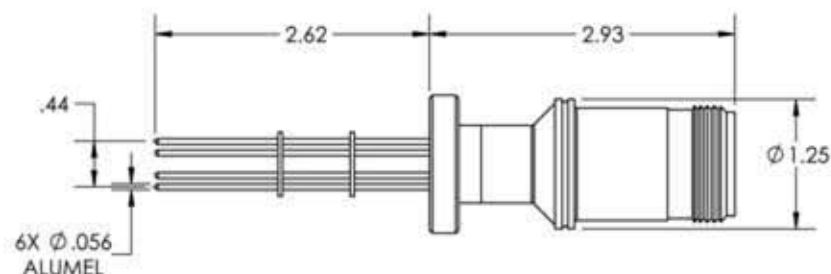

APPROVED

MS Series, Multipin Feedthrough, 6 Pins, 700 Volts, 10 Amps per Pin, 0.056" Dia Conductors
w/ Air-side Connector, 1.33" Conflat Flange

TITLE:

MULTIPIN, 6 PIN, 700V, 10A, 133CF

PROPRIETARY AND CONFIDENTIAL

UNLESS OTHERWISE SPECIFIED:

MPF PRODUCTS INC.

ANY REPRODUCTION IN PART OR AS A WHOLE WITHOUT THE
WRITTEN PERMISSION OF MPF PRODUCTS INC. IS PROHIBITED.

USED ON:

DIMENSIONS ARE IN INCHES
TOLERANCES:

ANGULAR: MACH ± 1/2 °
TWO PLACE DECIMAL
THREE PLACE DECIMAL



FINISH
CF FLANGE

DRAWN BY

JB

DATE

CHECKED

JB

DO NOT SCALE DRAWING

ENG APPR.

JB

SIZE

A

DWG. NO.

A0192-8-CF

REV

5/2/2013

LAST SAVED DATE

Thursday, April 11, 2013 4:58:12 AM