

A0266

REV

8/21/2013

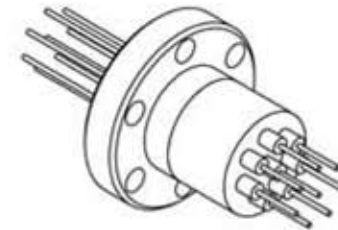
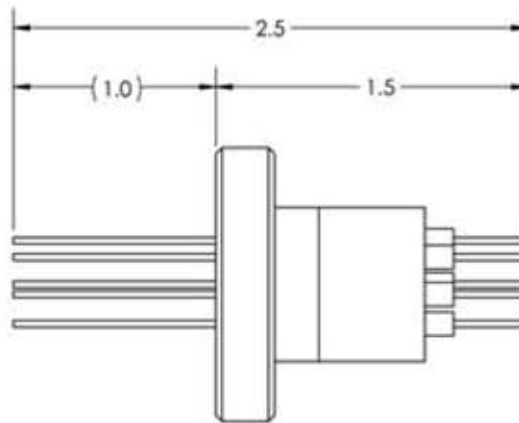
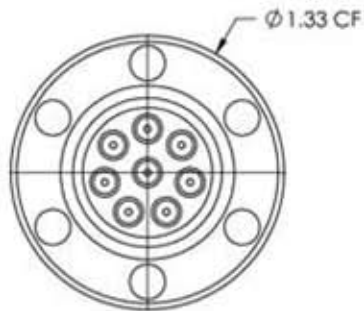

Ø .032  
SEE TABLE  
FOR CONDUCTOR  
MATERIAL

PART #	CONDUCTOR MATERIAL	AMPS
A0266-1-CF	NICKEL	5
A0266-2-CF	STN STL	1
A0266-3-CF	COPPER	15
A0266-4-CF	MOLYBDENUM	8

APPROVED

Power Feedthrough, 500 Volts, 8 Pins, 0.032" Conductors, 1.33" Conflat Flange

TITLE:

POWER, 500V, 8PIN, 133CF

<b>PROPRIETARY AND CONFIDENTIAL</b>		<b>UNLESS OTHERWISE SPECIFIED:</b>		<b>MPF PRODUCTS INC.</b>				
ANY REPRODUCTION IN PART OR AS A WHOLE WITHOUT THE WRITTEN PERMISSION OF MPF PRODUCTS INC. IS PROHIBITED.		DIMENSIONS ARE IN INCHES TOLERANCES:			FINISH	DRAWN BY	JB	DATE
USED ON:		ANGULAR: MACH ± 1/2 ° TWO PLACE DECIMAL THREE PLACE DECIMAL			CONFLAT	CHECKED		
		± .030 ± .015		DO NOT SCALE DRAWING	ENG APPR.	JB		DWG. NO. <b>A0266</b>
								REV 8/21/2013
								LAST SAVED DATE Tuesday, August 20, 2013 9:53:55 AM



Engineering Assistance  
Custom parts & modifications  
Available on all parts

In-House Manufacturing  
Manufactured on-site to  
our high quality standards

Fast Turnaround  
Quick shipping on stock parts  
and quick design on custom parts

For Questions or to Order:

1-866-429-4224  
MPFPI.com  
sales@mpfpi.com