

ITEM # 1	ITEM # 2
426	405

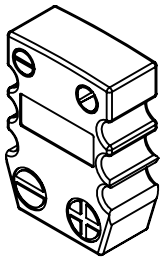

<p>UNLESS OTHERWISE SPECIFIED:</p> <p>DIMENSIONS ARE IN INCHES [] DIMENSIONS ARE IN MILLIMETERS FOR REFERENCE</p> <p>TOLERANCES: ANGULAR: MACH $\pm 1/2^\circ$ TWO PLACE DECIMAL $\pm .030$ [.76] THREE PLACE DECIMAL $\pm .015$ [.38]</p> <p>ALL DIAMETERS CONCENTRIC WITHIN .005 [.127] REMOVE ALL BURRS AND SHARP EDGES</p> <p>MIN SURFACE FINISH: Ra 63 μm Ra 1.6 μm N7</p> <p>THIRD ANGLE PROJECTION: </p>	QUOTATION #:		NOT APPROVED		
			NAME	DATE	MPF PRODUCTS INC. TITLE: THERMOCOUPLE SINGLE PAIR TYPE C WELDABLE
	DRAWN:	AB	11/21/2007		
	CHECKED:	RD	11/21/2007		
	APPROVED:	AB	11/21/2007		
		APPLICATION			
USED ON:		BASED ON:			
MOUNT: WELDABLE		WEIGHT: 0.03		DWG NO: A0389-1-W REV:	
				Friday, December 1, 2017 8:39:48 AM - BY: ENG2	